

**Paradise Honors Middle School**  
Informational Meeting

---

Preparing for the 2017-2018 School Year

# Agenda

- Transition Plan
- Transportation
- Student Schedules
- Before & After Care
- PHMS Academic & Behavior Expectations
- Athletics & Extracurricular
- Supply Fee
- Culminating Events
- Upcoming Events (Orientation, Curriculum Night, & ELA/Math Night)

# Transition Plan

PHMS will be sharing campuses with PEC and PHHS as we wait for the new campus construction to be completed.

**6th & 7th Grade** will be housed at the PEC campus for first quarter. Locations for classrooms will be the computer labs, library, K-Building, A-Building, C-Building, & E- Building. Elective teachers will travel to students.

**8th Grade** will be housed at the PHHS campus the first quarter. Locations of classroom will be in Building E. Elective teachers will travel to students. Eighth graders will be in the new buildings and on separate schedule from high school students to minimize overlap. Eighth graders will have very limited contact with high school students.

# PHMS on PHHS Campus for First Quarter

Front Office

8th Grade Building

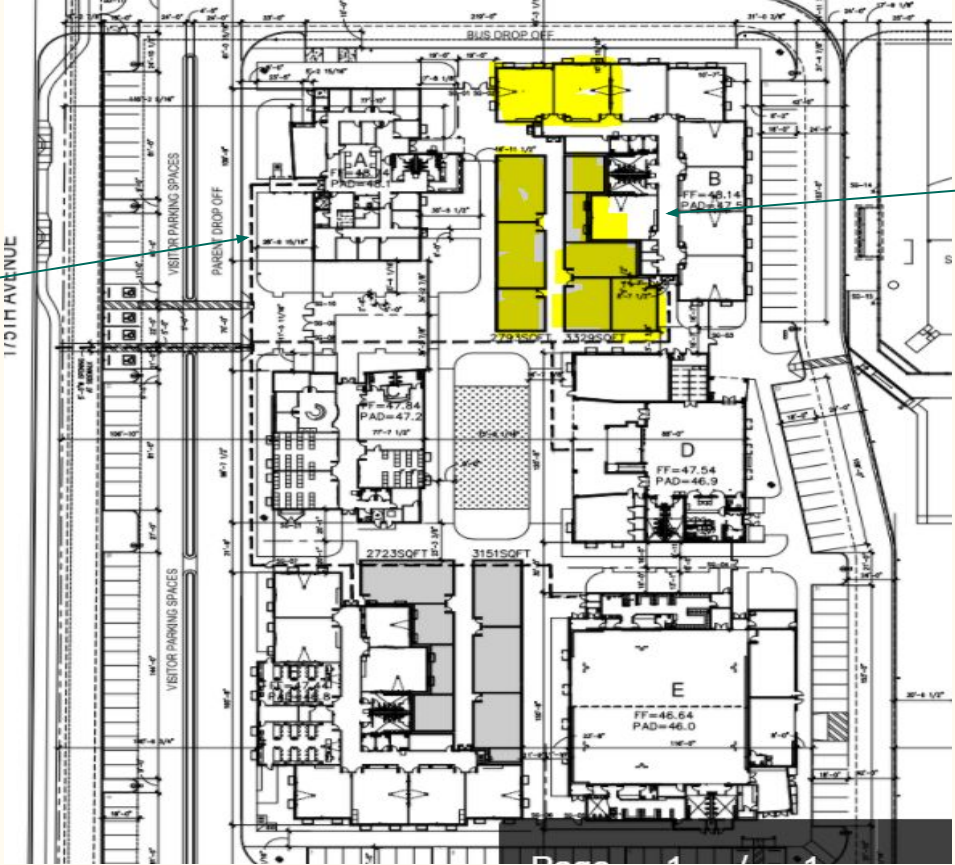

# PHMS on PEC Campus First Quarter

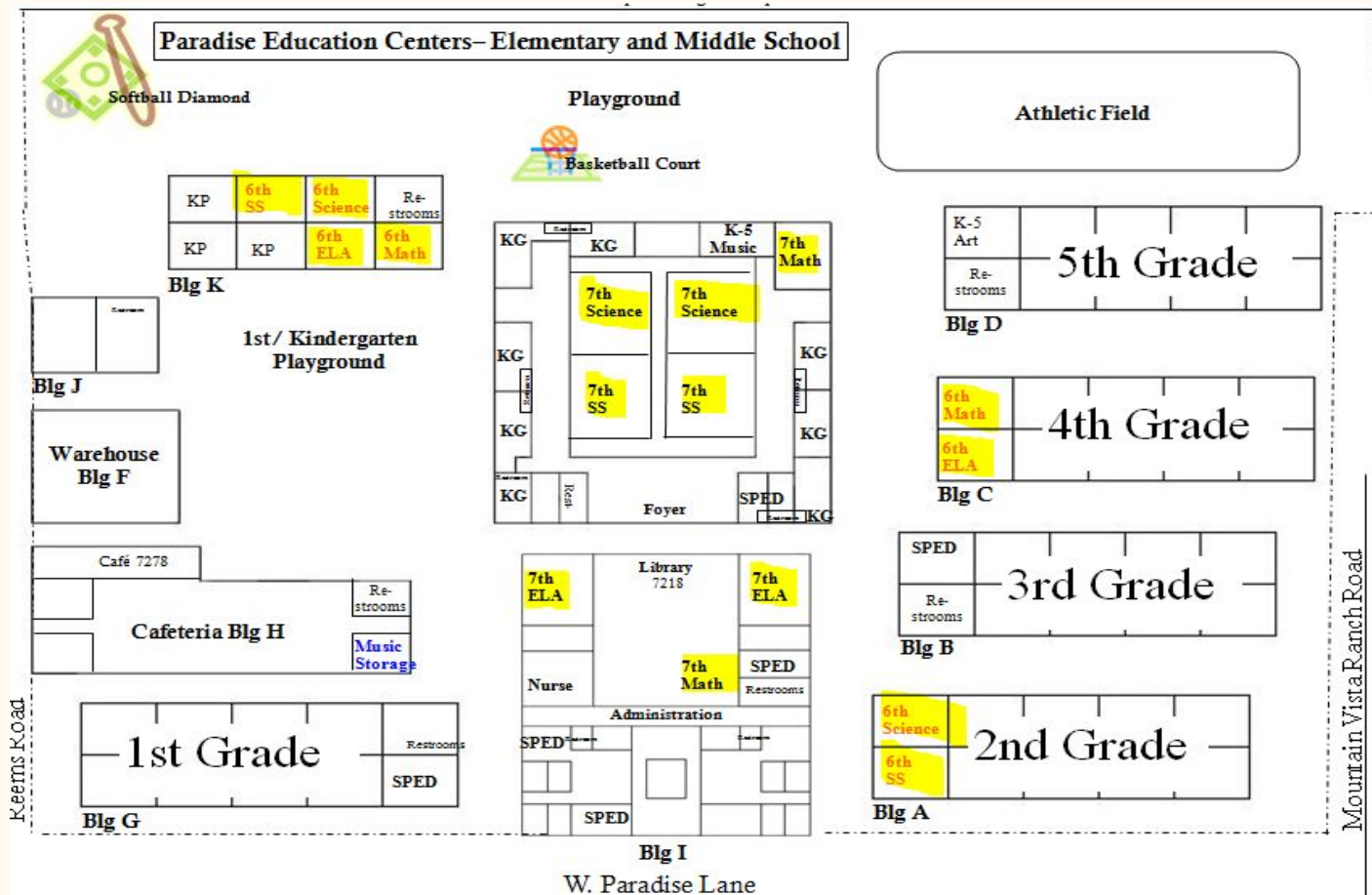

# Transportation

## Short Term Scenario:

Parents of 6th & 7th grade students that have siblings in 8th-12th grade will be provided the option of free transportation from PHHS campus for first quarter transition plan. Due to the delay of opening the campus next door to PHHS, this service is provided to 6th and 7th graders with 8th-12th grade sibling that will be dropped off and picked up at the PHHS campus.

# Transportation

Long Term Scenario: \$185 per Semester/\$325 per year

Parents may apply to secure a paid spot on a bus that runs between all three campus. ***IF*** parents will need this spot 2nd quarter or beyond, they must fill out form and pay appropriate fees.

**Please drop off form with payment to PHHS campus. Spots are first come first serve.**

(Note- Parents that do not need the bus 1st QT due to 6th & 7th grade being housed at PEC Campus will have a adjusted rate)

# Bus Schedule

	Start	End			
PEC	7:45	2:45			
PHMS	8:15	3:20			
PHHS	7:55	2:20			
Bus Runs					
	Leave		Arrive	Students	
	PHHS 6:55		PEC 7:10	k-5	
	PEC 7:15		PHHS 7:30	9-12	
	PHHS 7:35		PEC 7:50	6th/7th	
	PEC 7:55		PHMS 8:10	6-8	
	PHHS 2:30		PEC 2:45	9-12	
	PEC 2:50		PHMS 3:10	k-5	
	PHMS 3:30		PEC 3:45	6-8 (8)	
	PEC 3:50		PHMS 4:05	6th/7th	

Highlighted: 6th & 7th Graders of 8th-12th siblings free bus to and from temporary PEC campus during first quarter.

All other times are the paid bus service.



# Daily Schedule

PHMS

	Start	End
PEC	7:45	2:45
PHMS	8:15	3:20
PHHS	7:55	2:20

6:00 AM- Before Care

7:30 AM- Gates Open

8:15 AM- School Begins

3:20 School Dismissed

Dismissal-6:00 PM- After Care

(Before/After Care is for pay program- Interest forms available after meeting or on website)

---

# Before & After Care

PHMS

Before care and after care will be provided for 6-8th grade students at both the PEC campus and PHHS campus. The times and cost will be the same as the existing Eagles' Nest program. After first quarter, the before and after care program for 6-8th grade will be at PHMS.

---

# Sixth Grade Schedule Sample

**8:15 – 8:25**

**Homeroom**

**8:30 – 9:30**

**Specials - PE, Music, Tech or Spanish**

**9:35 – 10:35**

**Science**

**10:40 – 11:05**

**Lunch**

**11:10 – 11:35**

**Character Education**

**11:40 – 12:40**

**Language Arts**

**12:45 – 1:45**

**Social Studies**

**1:50 – 2:50**

**Math**

**2:55 – 3:20**

**Panther PLUS**

# Seventh Grade Schedule Sample

**8:15 – 8:25**

**Homeroom**

**8:30 – 9:30**

**Math**

**9:35 – 10:35**

**Language Arts**

**10:40 – 11:40**

**Specials 1<sup>st</sup> Quarter PE, Musical Keyboards**

**Spanish 1, Chorus or Band**

**11:45 – 12:10**

**Lunch**

**12:15 – 12:40**

**Character Ed**

**12:45 – 1:45**

**Social Studies**

**1:50 – 2:50**

**Science**

**2:55 – 3:20**

**Panther PLUS**

# Eighth Grade Schedule Sample

**8:15 – 9:30**

**Specials - PE, Art, Japanese or Band**

**9:35 – 10:35**

**Social Studies**

**10:40 – 11:40**

**Language Arts**

**11:45 – 12:10**

**Panther Plus**

**12:15 – 12:40**

**Character Ed**

**12:45 – 1:10**

**Lunch**

**1:15 – 2:15**

**Math**

**2:20 – 3:20**

**Science**

# Academic Support & Expectations

Paradise Schools

ELA & Math Pathways

Panther Plus

Tutoring

Special Education Services

Academic Support Plan

Academic Probation

---

# High Academic Expectations

## Sixth through Eighth Grade

	<b>F</b>	<b>C-</b>	<b>C</b>	<b>C+</b>	<b>B-</b>	<b>B</b>	<b>B+</b>	<b>A-</b>	<b>A</b>	<b>A+</b>
(%)	<b>69</b>	73	76	79	83	86	89	93	96	100
	<u>Below</u>	<u>70-</u>	<u>74-</u>	<u>77-</u>	<u>80-</u>	<u>84-</u>	<u>87-</u>	<u>90-</u>	<u>94-</u>	<u>97-</u>

# PHMS

## Character Education & Study Skills

Each day students will participate in a Character Education/Study Skills Lab. During this graded class, teachers will focus on character education, bully prevention, wellness, study skills, individual learning goals, and Genius Hour.

---



# PHMS

## Panther Plus

Panther Plus will be held at the end of each school day. Students will be assigned to attend Panther Plus class based on teacher request or student choice. Panther Plus will focus on providing additional support or extension across all content areas within the school day.

---

# Behavior Expectations & Consequences

Paradise Schools

Discipline with Dignity

Natural Consequences

Before School Detention

Community Service

Student violence, harassment,  
intimidation, & bullying policy

Cyberbullying

Cell Phones at School

# School Uniforms

PHMS

The existing uniform policy will continue to support an environment conducive to a quality learning opportunity for the children that attend PHMS.

---

# Athletics

PHMS will continue to offer two types of sport programs to our students. The first program is our competitive teams for tackle football, flag football, soccer, baseball, volleyball, basketball, cross country, cheer, color guard, and softball. PEC also offers an intramural program for all students. Please contact our Athletic Director, Van Hardy, at [vhardy@paradiseshools.org](mailto:vhardy@paradiseshools.org) for practice locations.

---

# Clubs

PHMS is proud to facilitate several school-sponsored clubs for our students. Students are encouraged to join additional clubs as an enhancement to their educational experience. These clubs will require fees to participate of at least \$25 per student. These fees cover supplies, speakers, and miscellaneous necessities. Each year, new clubs are announced to students and placed on our middle school announcement page.

---

## The Four Cs of 21st Century Skills

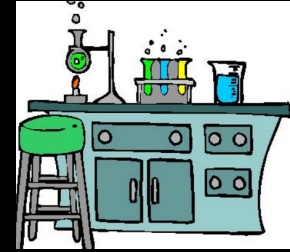
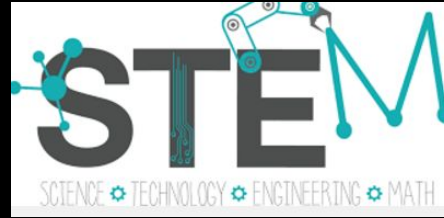
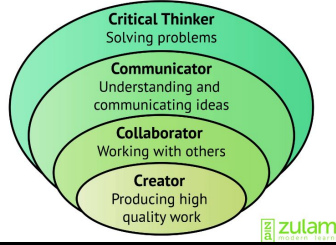

# Supply Fee

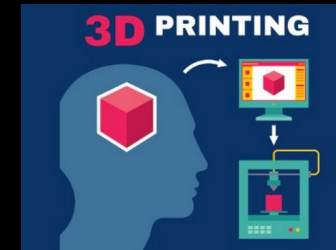

# Supply Cost Comparison

Beginning of the Year Recommended Supplies:

(Reported parent spending ranging from purchases at Walmart, Online, Target, and Staples)

2-3 Binders: \$7-\$14

5 Folders: \$6-\$10

5 Spiral Notebooks: \$8-\$10

Notebook Paper: \$3-\$5

Graph Paper: \$2-\$5

Colored Pencils: \$5-\$7

Markers: \$5-\$7

Pencils: \$2-\$5

Pens: \$2-\$5

Glue Sticks: \$3-\$5

Scissors: \$2-\$6

Sharpies: \$7-\$9

Dry Erase Markers: \$6-\$10

Ruler: \$2-\$5

Protractor: \$3-\$7

Compass: \$6-\$9

Calculator: \$15-\$20

Poster Board for Projects: \$2-\$5

Replenish Supply Throughout Year: \$25-\$50



**Approximate Reported Parent Cost: \$194**

**PHMS Supply Fee: \$150**

**ALL Day to Day Supplies for school year**

**One-to-One Chromebook for each student**

**Enhanced technology resources, science lab resources, electronic subscriptions, 21st century projects, STEM projects**

Annual Supply



# Supply Payment Form (available online and front office)



**Paradise Schools**

**PHMS Supply Fee Payment Form**

Student Name: \_\_\_\_\_ Grade: \_\_\_\_\_

Method	Payment Method(s) Payment Details	Date	Staff Initials									
Cash	Total Collected:											
Check	Please make checks payable to Paradise Schools <div style="border: 1px solid black; padding: 2px; margin-top: 5px;">Check Number:</div> <div style="border: 1px solid black; padding: 2px; margin-top: 5px;">Amount</div>											
Credit/Debit	Full Payments: Payment Amount: : <div style="border: 1px solid black; width: 100px; height: 15px; display: inline-block;"></div> Please attach credit card receipt to this form.  Partial Payments: <table border="1" style="width: 100%; border-collapse: collapse; margin-top: 5px;"> <thead> <tr> <th style="width: 30%;">Partial Payments</th> <th style="width: 30%;">Amount</th> <th style="width: 40%;">Date</th> </tr> </thead> <tbody> <tr> <td>Payment 1</td> <td style="text-align: center;">\$75</td> <td style="text-align: center;">8/5/17</td> </tr> <tr> <td>Payment 2</td> <td style="text-align: center;">\$75</td> <td style="text-align: center;">9/4/17</td> </tr> </tbody> </table> If paying by credit card, parent or guardians may choose 2 partial payments to be automatically billed to credit card. <b>Please see front office for appropriate automatic processing form.</b>	Partial Payments	Amount	Date	Payment 1	\$75	8/5/17	Payment 2	\$75	9/4/17		
Partial Payments	Amount	Date										
Payment 1	\$75	8/5/17										
Payment 2	\$75	9/4/17										

Comments:

**Deadline for Supply Fee: August 3, 2017 (or at orientation)**

**Please note the supply fee is NOT tax credit eligible. Financial assistance is available for those that qualify. Please pick up an income verification form to apply for eligibility from the front office.**



# Technology does not replace best practices

“Technology alone,” Collins observed in *Good to Great*, “never holds the key to success.” However, “when used right, technology is an essential driver in accelerating forward momentum” (Collins, 2007, p. 159)

The reality may be that one-to-one programs are only as effective—or in effective—as the schools that adopt them.



Colorado River Quest

Proposed Sea Quest

## Culminating Events

PHMS

Leadership California Quest

PHMS students will participate in a class trip that culminates learning experiences of the grade level. These trips range in prices and are all tax credit eligible. With contributions of families and friends, students have the opportunity to travel unique places for at no cost.

---

# Upcoming Important Dates

PHMS

## Mandatory Student Orientation:

August 2nd **OR** August 3rd

1 PM- 3 PM

PHHS Gym

## Curriculum Night

October 25, 2017 5 PM-7:30 PM

## ELA & Math Night

January 10, 2018 6 PM- 7:30 PM

---

# Mandatory Student Orientation

Students find out course placement in Pathways and pick up schedules

Students and parents meet teachers and staff

Student IDs made

Pay \$150 supply fee

Information about athletics, band, ASI, and clubs

Grade level culminating event information

# Handouts (online or front office)

- Short Term Transportation Form (green form)
- Long Term Transportation Form (white form) - This form needs to be turned with payment to front office at PHHS

Semester (per seat)	\$185
Year (per seat)	\$325

- Supply Fee Payment Form (pay in front office or at orientation)
- Income Verification/Free & Reduced Lunch Application